

Brandong S.:\Land Projects\200607-Rickard Road\dwg\CIVIL\SHEETS\200607\_XSEC.dwg, Mon, Mar 15, 2021 -- 11:27am

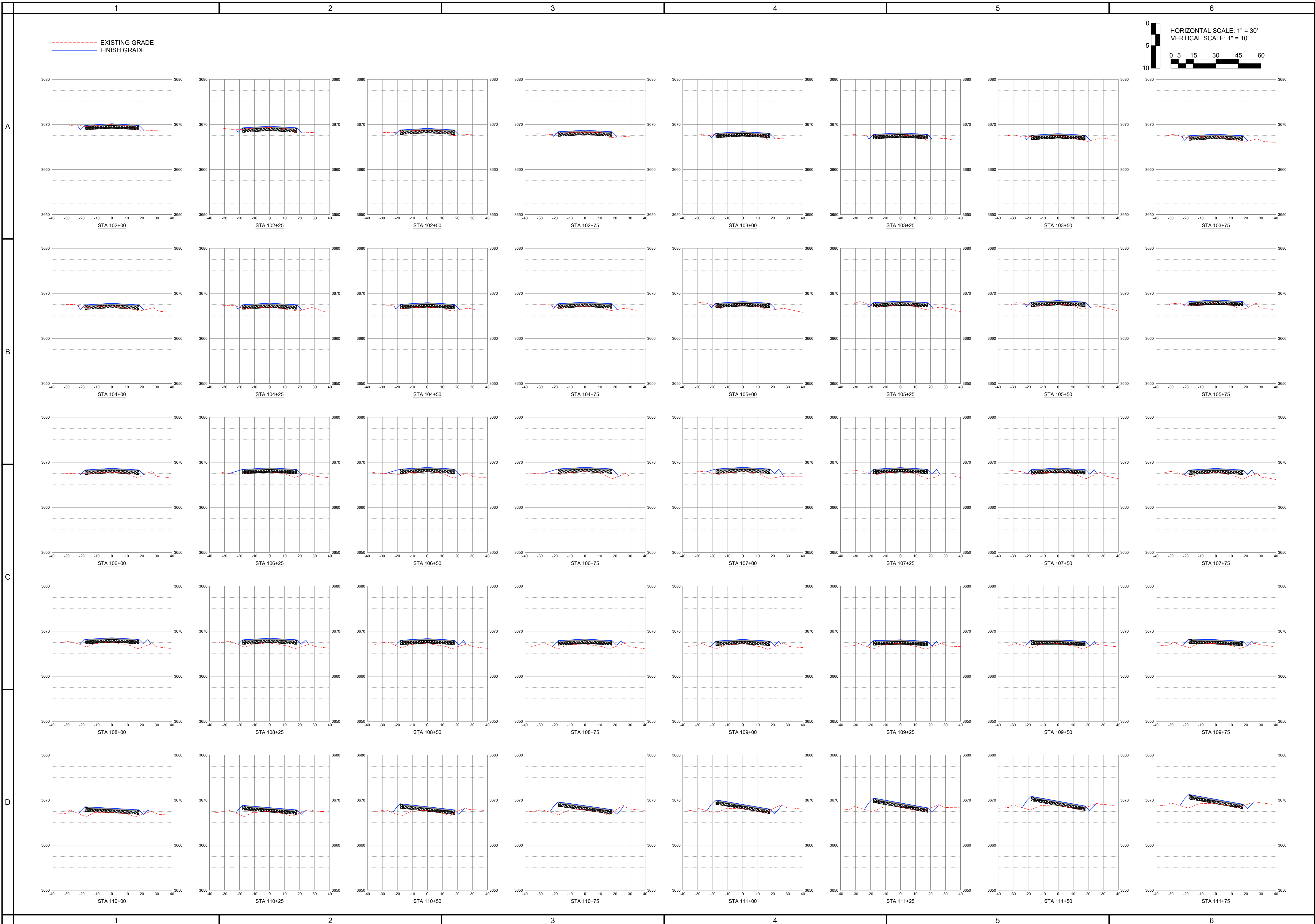

RICKARD RD: GROFF RD  
TO US20 IMPROVEMENT  
PUBLIC INFRASTRUCTURE PLANS  
RICKARD RD CROSS SECTIONS STA 102+00 TO STA 111+75  
DESCHUTES COUNTY, OREGON



REVISIONS:



DESIGNED BY: MPD  
DRAWN BY: BRG  
CHECKED BY: MPD  
SCALE: AS NOTED  
FILE: 200607\_XSEC.dwg  
DATE: 3/12/2021

VERIFY SCALES  
0 1"  
BAR EQUALS ONE INCH  
ON ORIGINAL DRAWING

SHEET:

X1.01

HWA # 200607  
DESCO # 2020-416

Brandong S.:\Land Projects\200607-Rickard Road\dwg\CIVIL\SHEETS\200607\_XSEC.dwg, Mon Mar 15, 2021 -- 11:28am

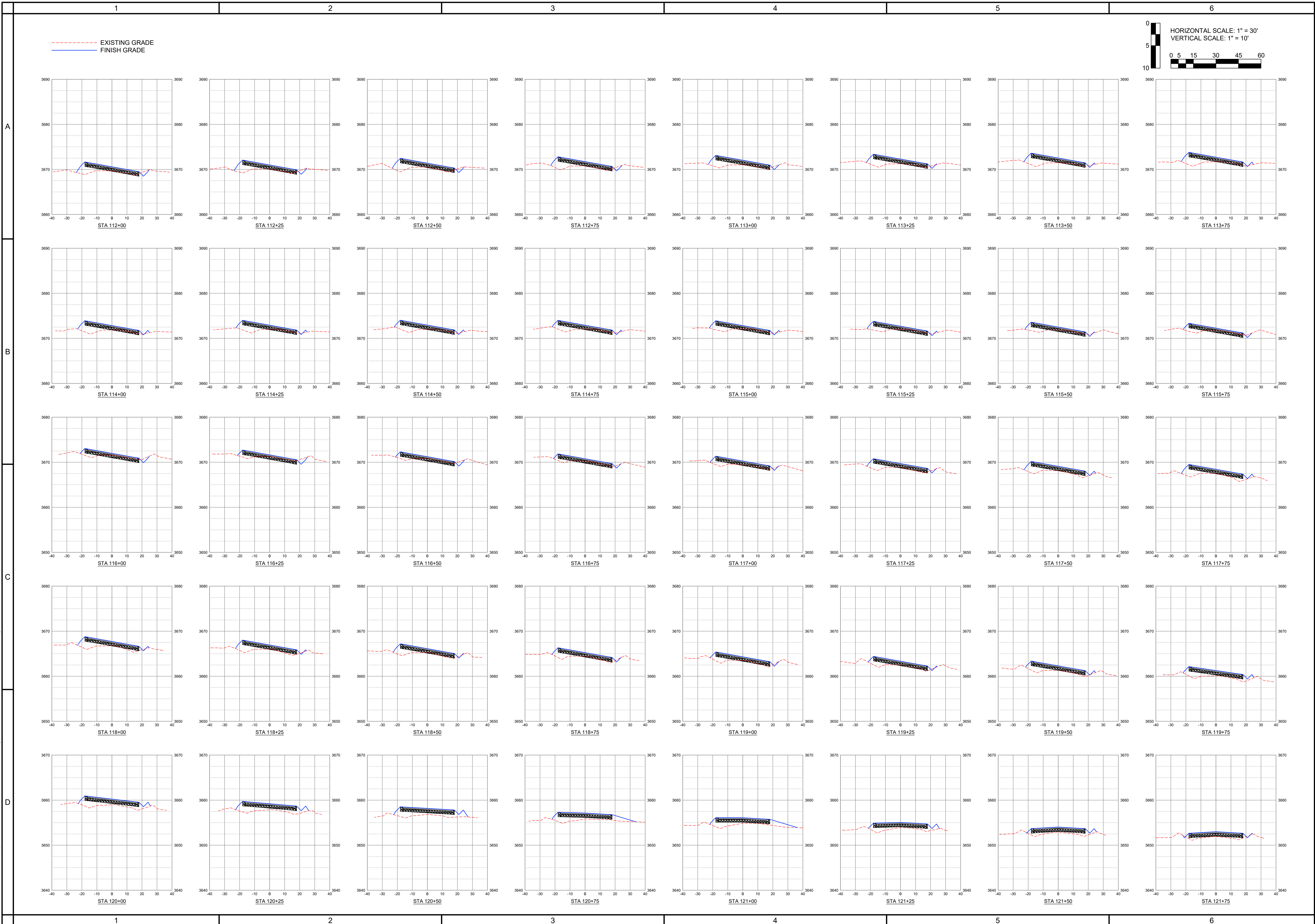

REGISTERED PROFESSIONAL  
ENGINEER  
19360PE  
OREGON  
JUL 22 1991  
MARK P. DOUGLAS  
EXPIRES: 12/31/2021

RICKARD RD: GROFF RD  
TO US20 IMPROVEMENT  
PUBLIC INFRASTRUCTURE PLANS  
RICKARD RD CROSS SECTIONS STA 112+00 TO STA 121+75  
DESCHUTES COUNTY, OREGON

DESCHUTES COUNTY

REVISIONS:

NO.	DESCRIPTION	DATE

CIVIL ENGINEERING / SURVEYING PLANNING  
1000 N. HWY 101, SUITE 100, BEND, OR 97703  
PHONE: 503.325.8888 FAX: 503.325.8888  
WEB: WWW.HWA-INC.ORG

DESIGNED BY: MPD  
DRAWN BY: BRG  
CHECKED BY: MPD  
SCALE: AS NOTED  
FILE: 200607\_XSEC.dwg  
DATE: 3/12/2021

VERIFY SCALES  
0 1"  
BAR EQUALS ONE INCH  
ON ORIGINAL DRAWING

SHEET:  
**X1.02**

HWA # 200607  
DESCO # 2020-416

Brandan S.:\Land Projects\200607-Rickard Road\dwg\CIVIL\SHEETS\200607\_XSEC.dwg, Mon Mar 15, 2021 -- 11:28am

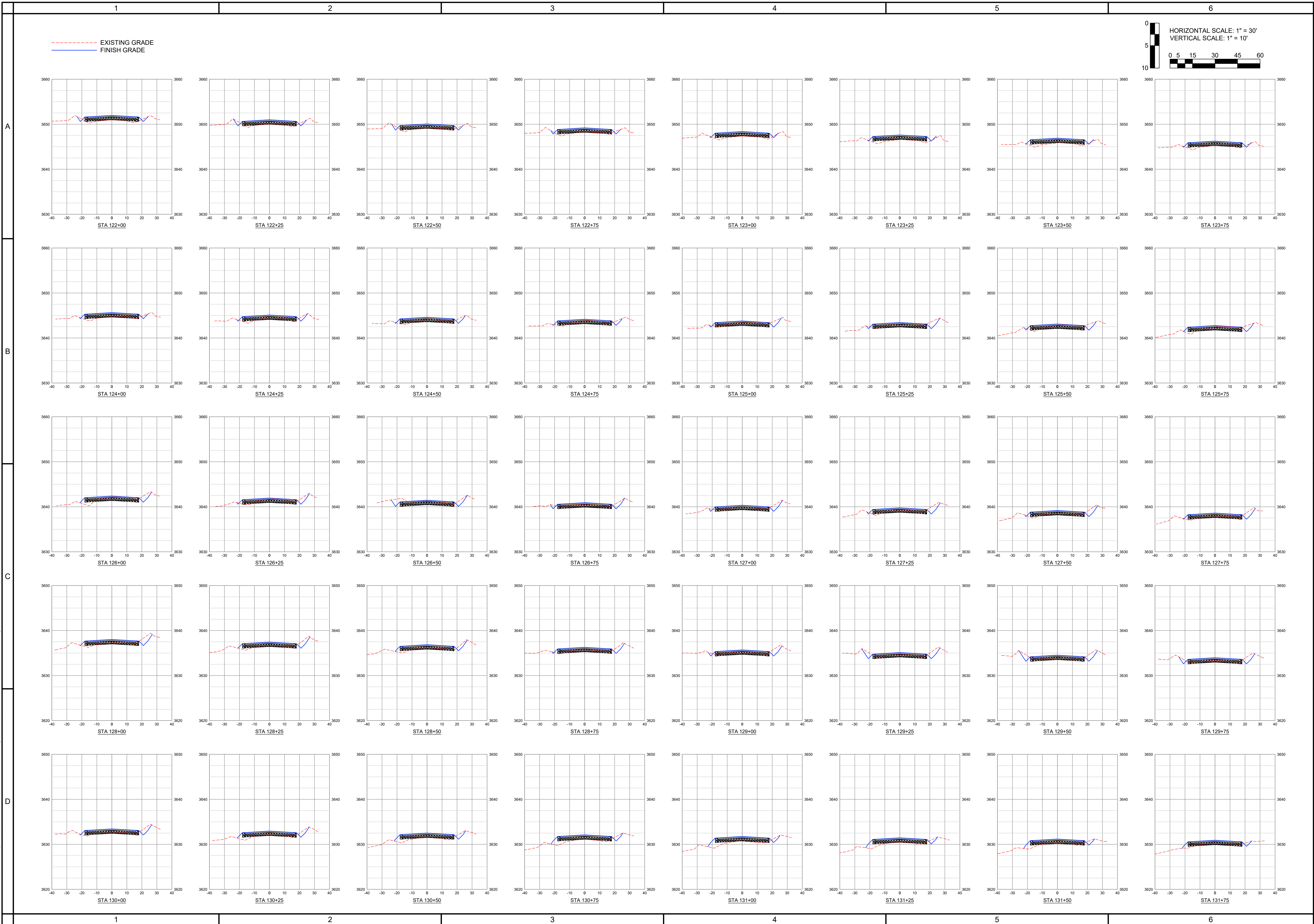

RICKARD RD: GROFF RD  
TO US20 IMPROVEMENT  
PUBLIC INFRASTRUCTURE PLANS  
RICKARD RD CROSS SECTIONS STA 122+00 TO STA 131+75  
DESCHUTES COUNTY, OREGON



REVISIONS:

**HWA**  
CIVIL ENGINEERING / SURVEYING PLANNING  
1000 N. RIVER ROAD, SUITE 100, BEND, OR 97703  
PHONE: 503.325.8888 FAX: 503.325.8841  
WEB: WWW.HWANHC.ORG

DESIGNED BY: MPD	BRG
DRAWN BY: MPD	BRG
CHECKED BY: MPD	BRG
SCALE: AS NOTED	FILE: 200607_XSEC.dwg
DATE: 3/12/2021	

VERIFY SCALES  
0 1"  
BAR EQUALS ONE INCH  
ON ORIGINAL DRAWING

SHEET:  
**X1.03**

HWA # 200607  
DESCO # 2020-416



Brandan S.:\Land Projects\200607-Rickard Road\dwg\CIVIL\SHEETS\200607\_XSEC.dwg, Mon Mar 15, 2021 -- 11:28am

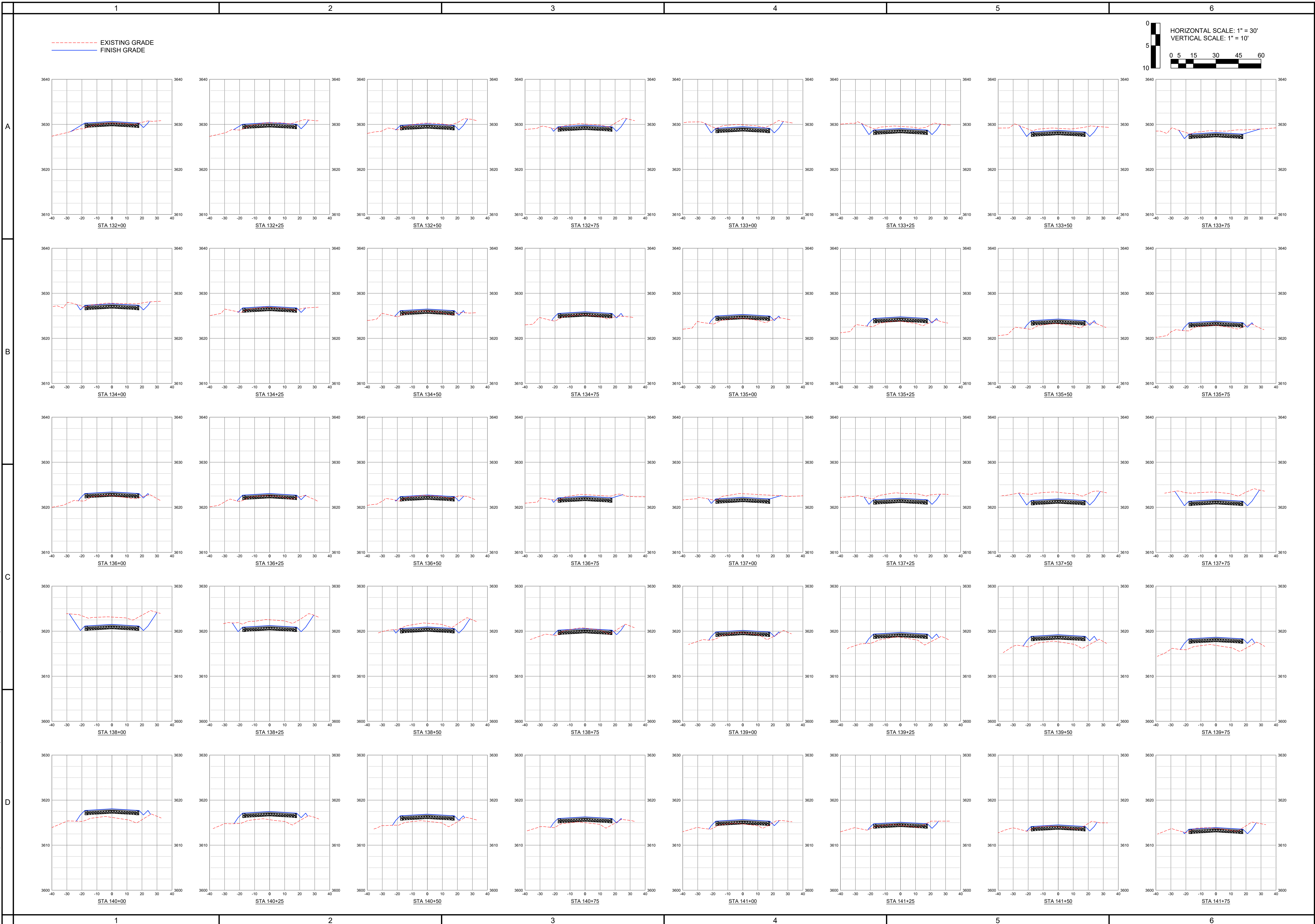

RICKARD RD: GROFF RD  
TO US20 IMPROVEMENT  
PUBLIC INFRASTRUCTURE PLANS  
RICKARD RD CROSS SECTIONS STA 132+00 TO STA 141+75  
DESCHUTES COUNTY, OREGON

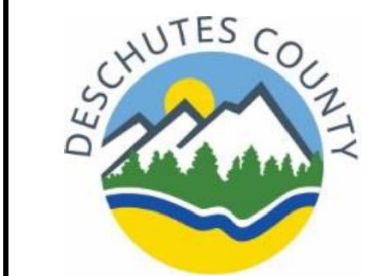

REVISIONS:



DESIGNED BY: MPD  
DRAWN BY: BRG  
CHECKED BY: MPD  
SCALE: AS NOTED  
FILE: 200607\_XSEC.dwg  
DATE: 3/12/2021

VERIFY SCALES  
0 1"  
BAR EQUALS ONE INCH  
ON ORIGINAL DRAWING

SHEET:  
X1.04  
HWA # 200607  
DESCO # 2020-416

BID REFERENCE DOCUMENT

Brandon S.:\Land Projects\200607-Rickard Road\dwg\CIVIL\SHEETS\200607\_XSEC.dwg Mon Mar 15, 2021 - 11:28am

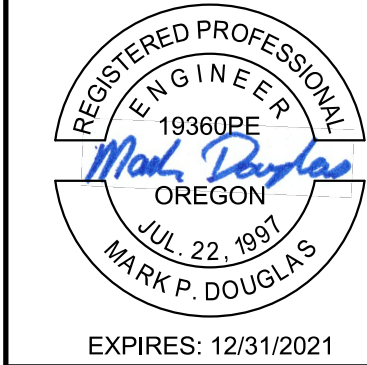
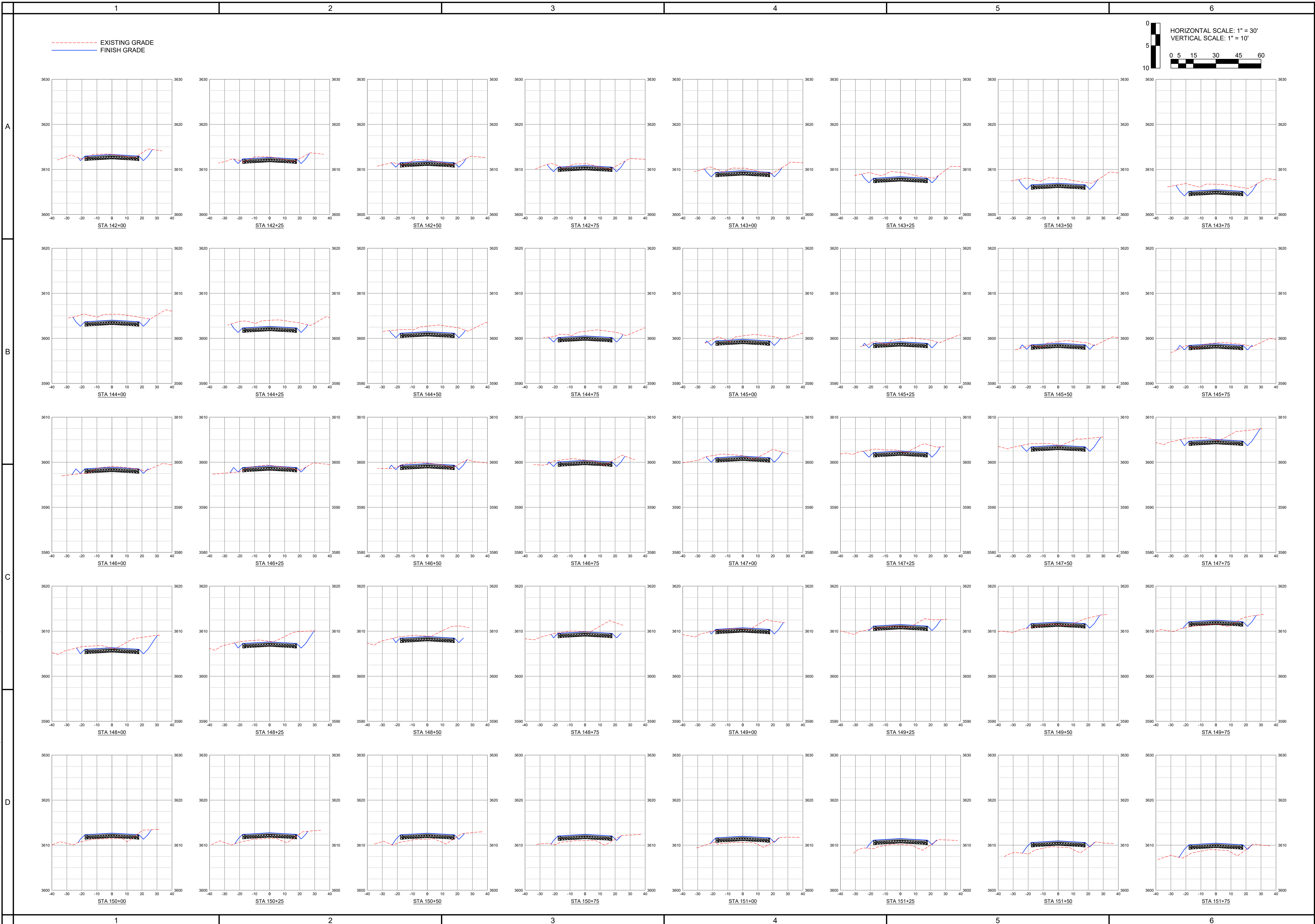

RICKARD RD: GROFF RD  
TO US20 IMPROVEMENT  
PUBLIC INFRASTRUCTURE PLANS  
RICKARD RD CROSS SECTIONS STA 142+00 TO STA 151+75  
DESCHUTES COUNTY, OREGON

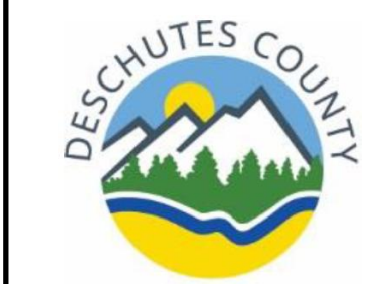

REVISIONS:



DESIGNED BY: MPD  
DRAWN BY: BRG  
CHECKED BY: MPD  
SCALE: AS NOTED  
FILE: 200607\_XSEC.dwg  
DATE: 3/12/2021

VERIFY SCALES  
0 1"  
BAR EQUALS ONE INCH  
ON ORIGINAL DRAWING

SHEET:  
X1.05

HWA # 200607  
DESCO # 2020-416

BID REFERENCE DOCUMENT

Brandong S:\Land Projects\200607-Rickard Road\dwg\CIVIL\SHEETS\200607\_XSEC.dwg, Mon, Mar 15, 2021 -- 11:29am

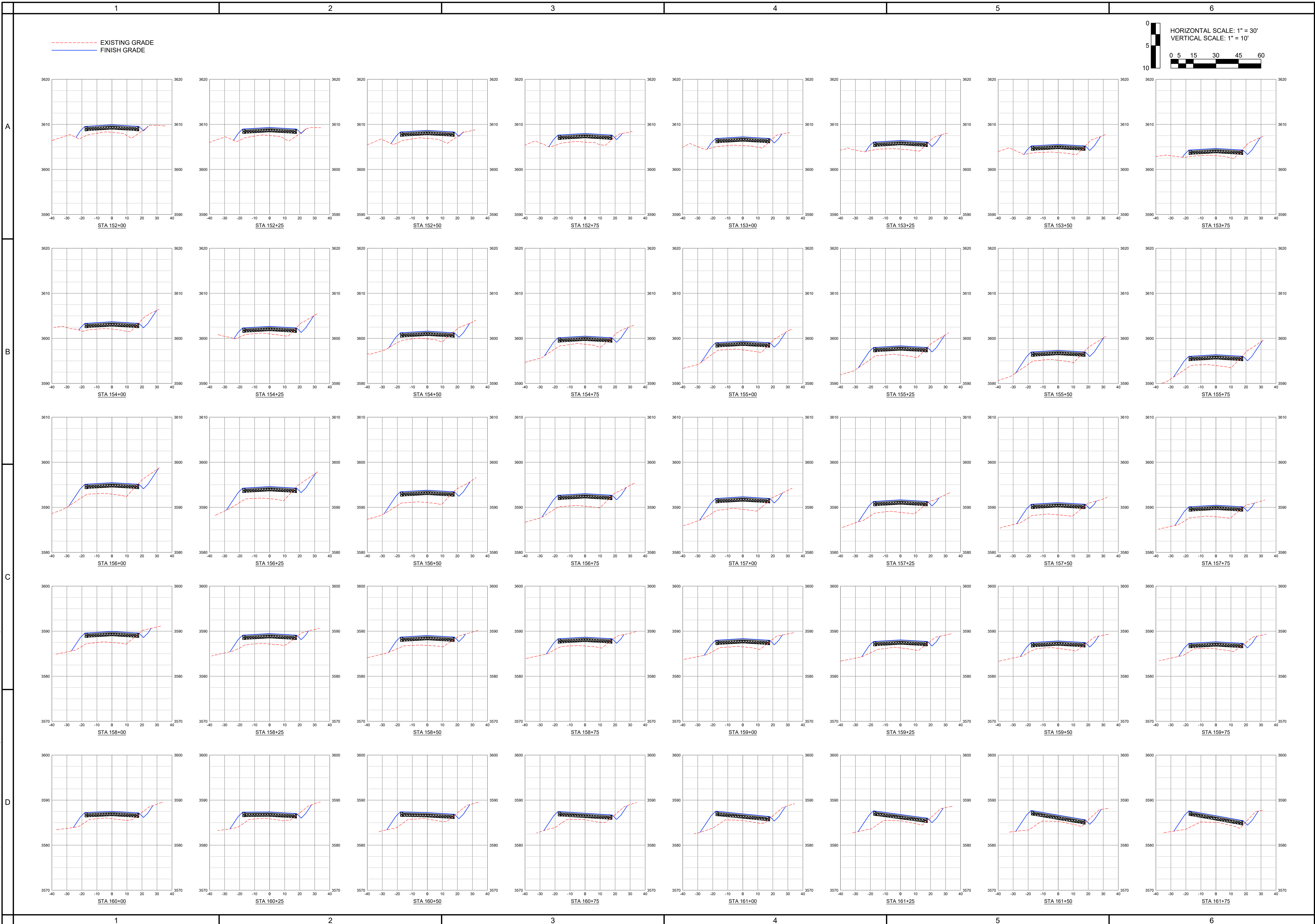

REGISTERED PROFESSIONAL  
ENGINEER  
OREGON  
19360PE  
JUL 22 1991  
MARK P. DOUGLAS  
EXPIRES: 12/31/2021

**RICKARD RD: GROFF RD  
TO US20 IMPROVEMENT  
PUBLIC INFRASTRUCTURE PLANS**

RICKARD RD CROSS SECTIONS STA 152+00 TO STA 161+75  
DESCHUTES COUNTY, OREGON

DESCHUTES COUNTY

REVISIONS:

NO.	DESCRIPTION	DATE

**HWA**  
CIVIL ENGINEERING / SURVEYING PLANNING  
1000 N. RIVER ROAD, SUITE 100, BEND, OR 97703  
PHONE: 503.938.5411 FAX: 503.938.5411  
WEB: WWW.HWANINC.ORG

DESIGNED BY: MPD  
DRAWN BY: BRG  
CHECKED BY: MPD  
SCALE: AS NOTED  
FILE: 200607\_XSEC.dwg  
DATE: 3/12/2021

VERIFY SCALES  
0 1"  
BAR EQUALS ONE INCH  
ON ORIGINAL DRAWING

SHEET:  
**X1.06**

HWA # 200607  
DESCO # 2020-416



Brandan S.:\Land Projects\200607-Rickard Road\dwg\CIVIL\SHEETS\200607\_XSEC.dwg, Mon Mar 15, 2021 -- 11:29am

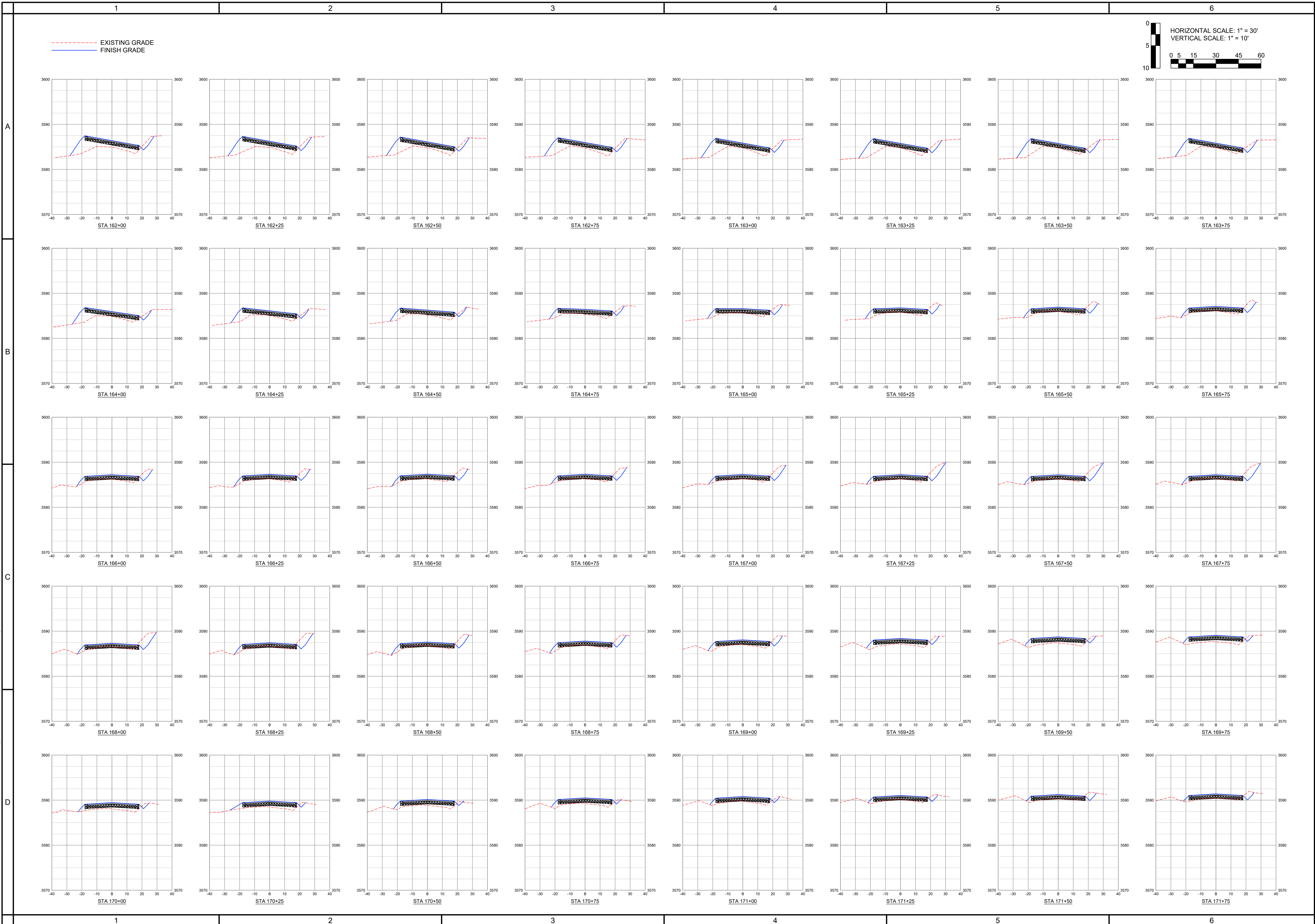

RICKARD RD: GROFF RD  
TO US20 IMPROVEMENT  
PUBLIC INFRASTRUCTURE PLANS  
RICKARD RD CROSS SECTIONS STA 162+00 TO STA 171+75  
DESCHUTES COUNTY, OREGON



REVISIONS:



DESIGNED BY: MPD  
DRAWN BY: BRG  
CHECKED BY: MPD  
SCALE: AS NOTED  
FILE: 200607\_XSEC.dwg  
DATE: 3/12/2021

0 1"  
BAR EQUALS ONE INCH  
ON ORIGINAL DRAWING

SHEET:  
X1.07

HWA # 200607  
DESCO # 2020-416

BID REFERENCE DOCUMENT

Brandan S.:\Land Projects\200607-Rickard Road\dwg\CIVIL\SHEETS\200607\_XSEC.dwg, Mon, Mar 15, 2021 -- 11:29am

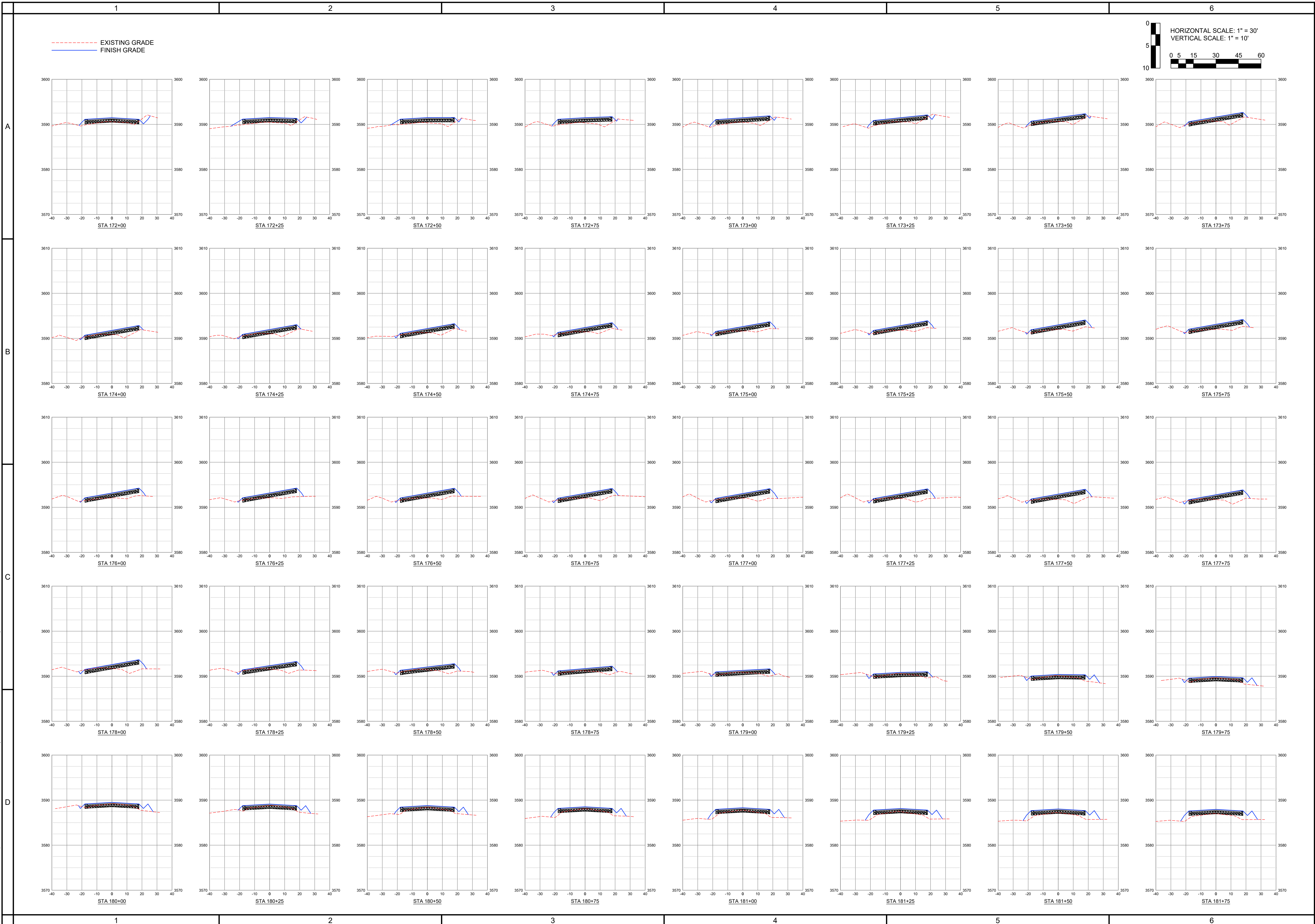

**RICKARD RD: GROFF RD  
TO US20 IMPROVEMENT  
PUBLIC INFRASTRUCTURE PLANS**

RICKARD RD CROSS SECTIONS STA 172+00 TO STA 181+75

DESCHUTES COUNTY, OREGON

REVISIONS:	

DESIGNED BY: MPD

DRAWN BY: BRG

CHECKED BY: MPD

SCALE: AS NOTED

FILE: 200607\_XSEC.dwg

DATE: 3/12/2021

VERIFY SCALES

0 1"

BAR EQUALS ONE INCH  
ON ORIGINAL DRAWING

SHEET:

X1.08

HWA # 200607

DESCO # 2020-416

BID REFERENCE DOCUMENT



Brandong S.:\Land Projects\200607-Rickard Road\dwg\CIVIL\SHEETS\200607\_XSEC.dwg, Mon Mar 15, 2021 -- 11:30am

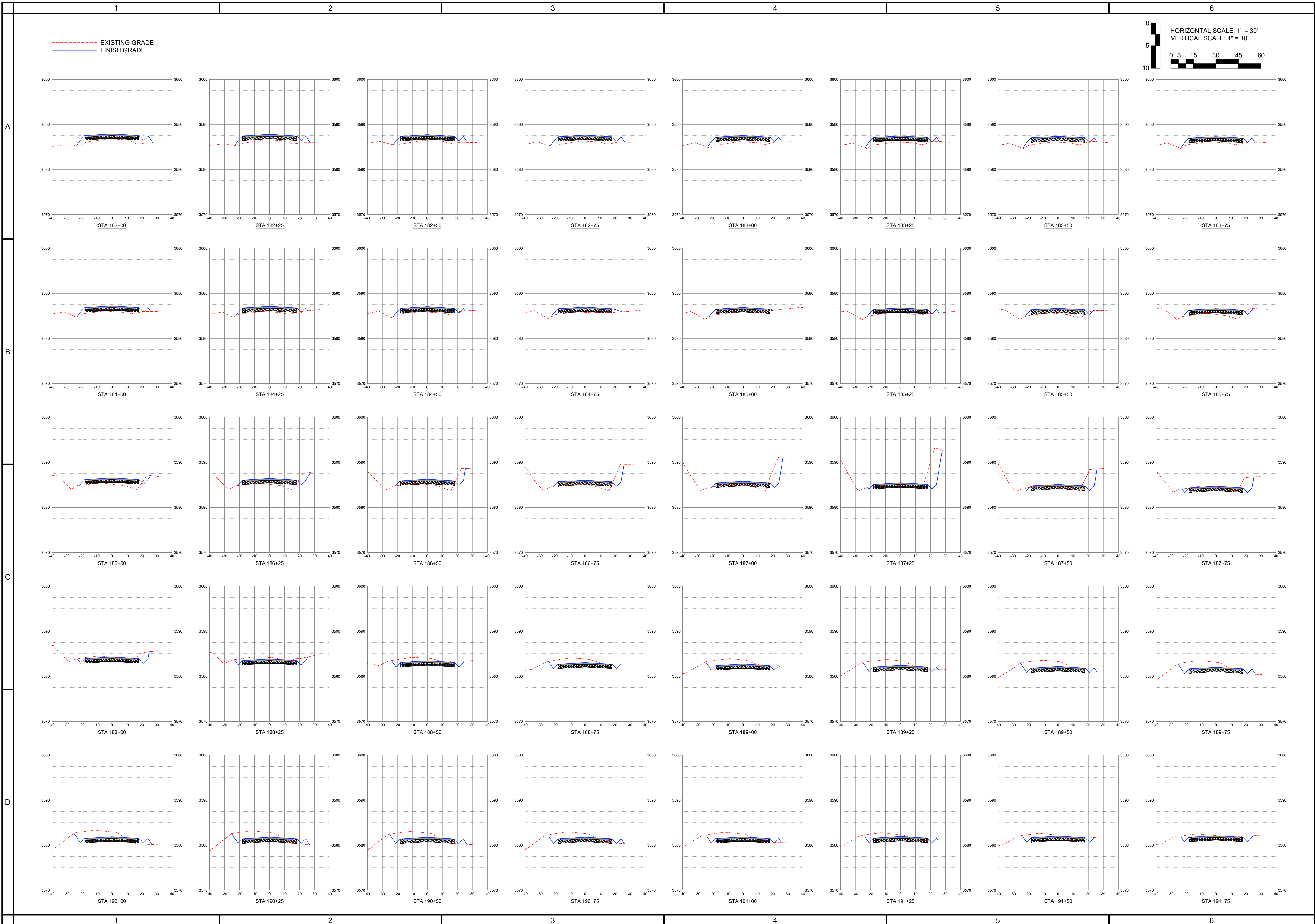

RICKARD RD: GROFF RD  
TO US20 IMPROVEMENT  
PUBLIC INFRASTRUCTURE PLANS  
RICKARD RD CROSS SECTIONS STA 182+00 TO STA 191+75  
DESCHUTES COUNTY, OREGON

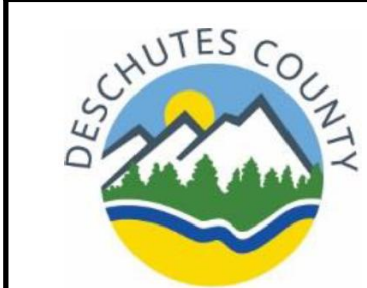

REVISIONS:



DESIGNED BY: MPD  
DRAWN BY: BRG  
CHECKED BY: MPD  
SCALE: AS NOTED  
FILE: 200607\_XSEC.dwg  
DATE: 3/12/2021

VERIFY SCALES  
0 1"  
BAR EQUALS ONE INCH  
ON ORIGINAL DRAWING

SHEET:  
X1.09

HWA # 200607  
DESCO # 2020-416

BID REFERENCE DOCUMENT

Brandong S.:\\Land Projects\\200607-Rickard Road\\dwg\\CIVIL\\SHEETS\\200607\_XSEC.dwg, Mon Mar 15, 2021 - 11:30am

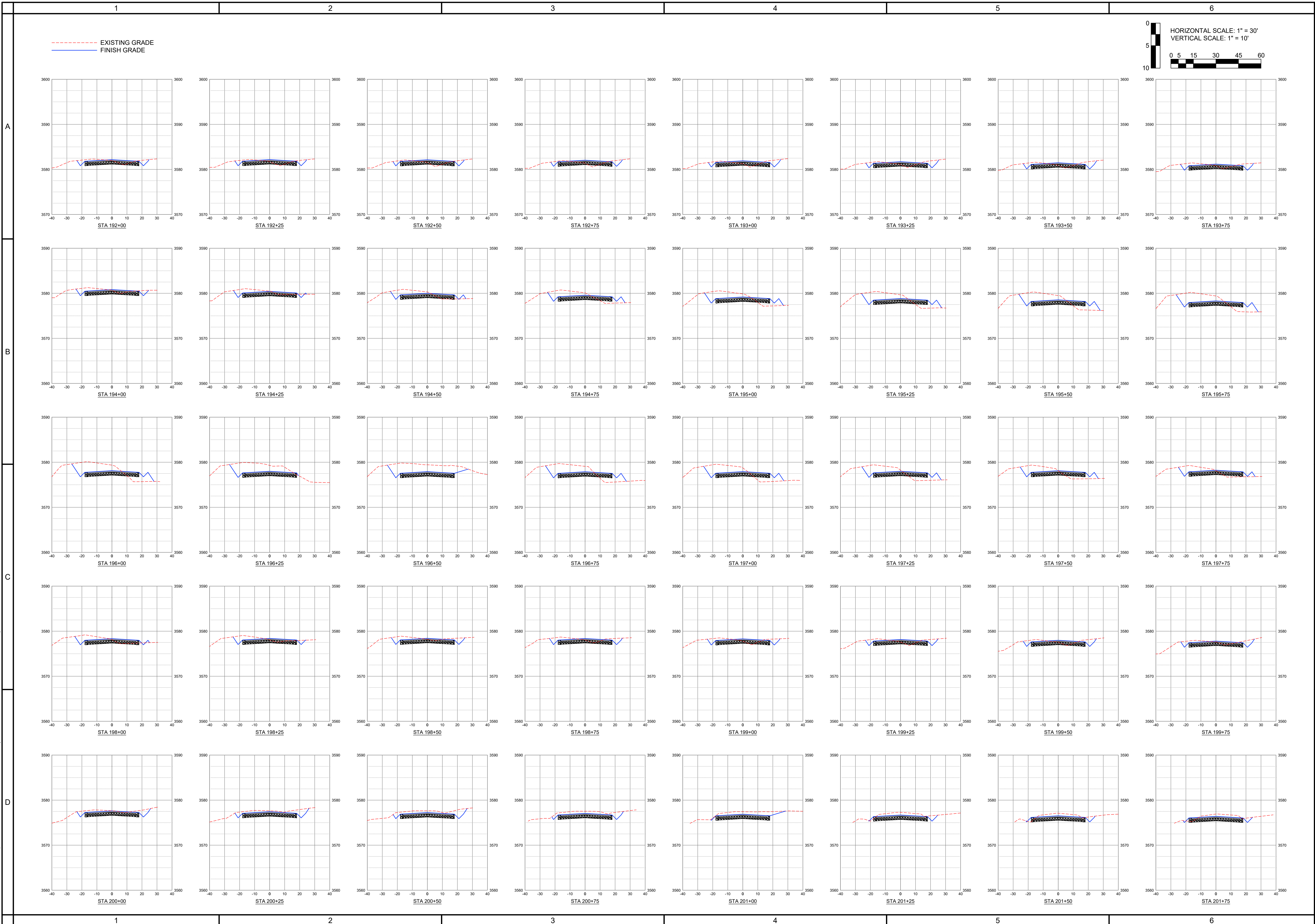

RICKARD RD: GROFF RD  
TO US20 IMPROVEMENT  
PUBLIC INFRASTRUCTURE PLANS  
RICKARD RD CROSS SECTIONS STA 192+00 TO STA 201+75  
DESCHUTES COUNTY, OREGON

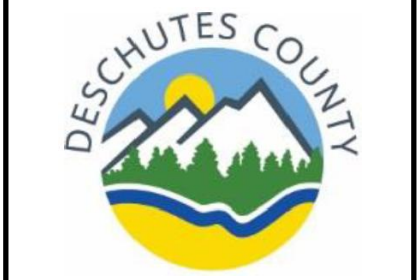

REVISIONS:



DESIGNED BY: MPD	BRG
DRAWN BY: MPD	BRG
CHECKED BY: MPD	BRG
SCALE: AS NOTED	FILE: 200607_XSEC.dwg
DATE: 3/12/2021	

VERIFY SCALES 0 1" BAR EQUALS ONE INCH ON ORIGINAL DRAWING
SHEET: X1.10
HWA # 200607 DESCO # 2020-416

Brandon S.:\Land Projects\200607-Rickard Road\dwg\CIVIL\SHEETS\200607\_XSEC.dwg Mon Mar 15, 2021 - 11:30am

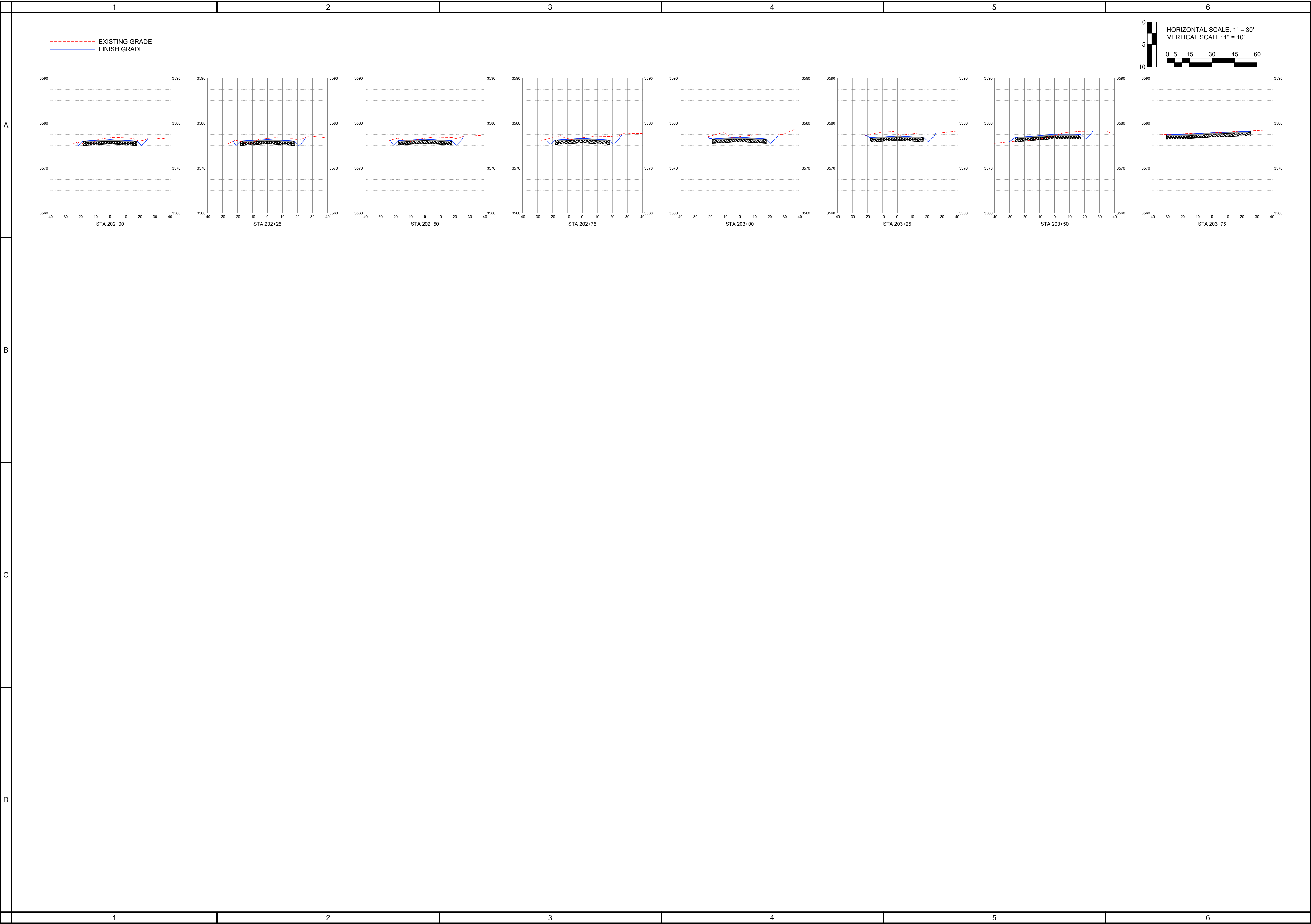

REGISTERED PROFESSIONAL  
ENGINEER  
19360PE  
OREGON  
JUL 22 1991  
MARK P. DOUGLAS  
EXPIRES: 12/31/2021

RICKARD RD: GROFF RD  
TO US20 IMPROVEMENT  
PUBLIC INFRASTRUCTURE PLANS  
RICKARD RD CROSS SECTIONS STA 202+00 TO STA 203+75  
DESCHUTES COUNTY, OREGON

DESCHUTES COUNTY

REVISIONS:

HWA

CIVIL ENGINEERING | SURVEYING | PLANNING  
2000 N. HWY 100, SUITE 100, BEND, OR 97703  
PHONE: 503.685.5551 FAX: 503.685.5511  
WEB: WWW.HWA-INC.ORG

DESIGNED BY: MPD  
DRAWN BY: BRG  
CHECKED BY: MPD  
SCALE: AS NOTED  
FILE: 200607\_XSEC.dwg  
DATE: 3/12/2021

VERIFY SCALES  
0 1"  
BAR EQUALS ONE INCH  
ON ORIGINAL DRAWING

SHEET:  
X1.11

HWA # 200607  
DESCO # 2020-416

BID REFERENCE DOCUMENT