

REFERENCE PLAT
FOR
DESCHUTES GEODETTIC MAPPING CONTROL #18
FOR THE
EXPANSION OF DESCHUTES COUNTY PRIME CONTROL NETWORK

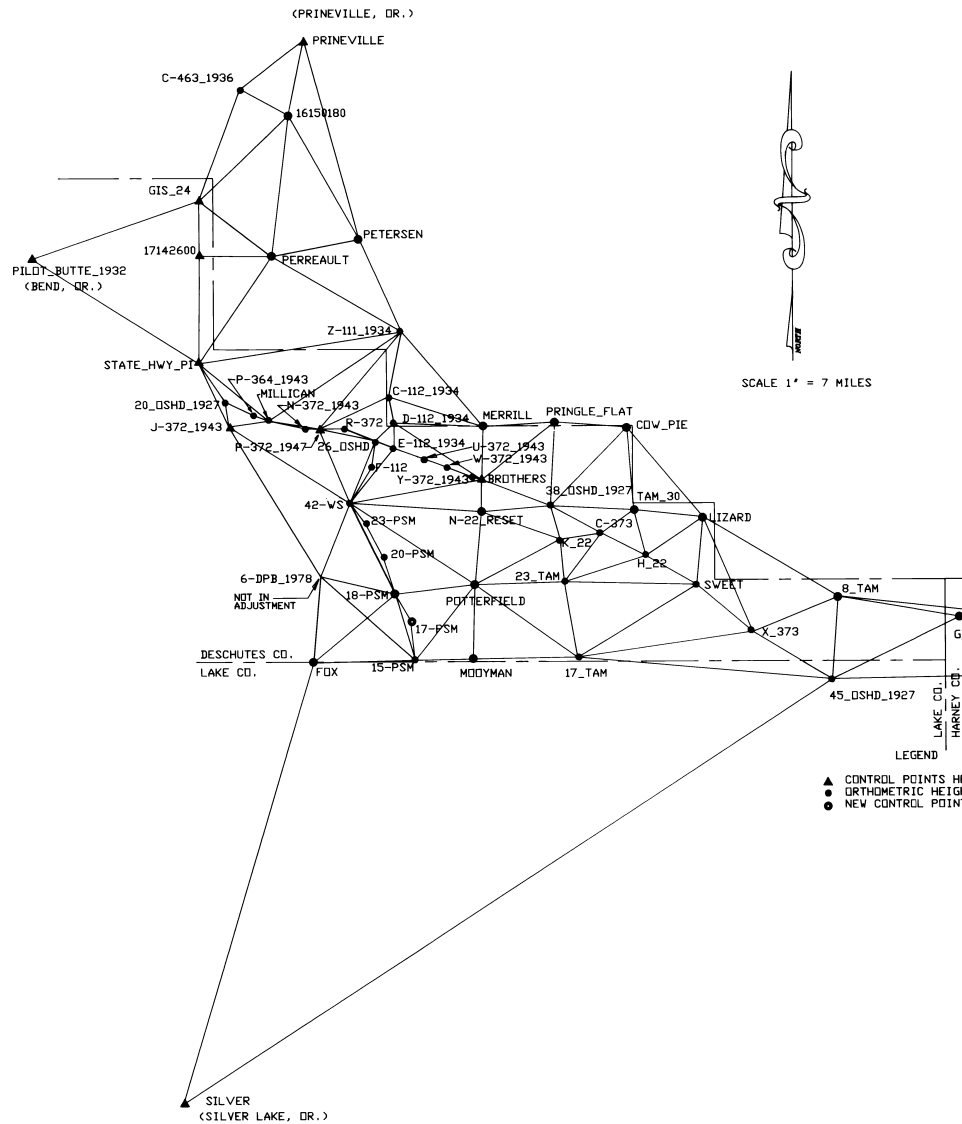

NEW CONTROL POINTS
CENTRAL OREGON COORDINATE SYSTEM

DATUM, NAD83(91) NGVD 29	INTERNATIONAL INTERNATIONAL	FOOT FOOT	COORD. SYS.	TRANSVERSE SCALE FACTOR 1.000160	MERCATOR ORIGIN NORTH 0.00	CENTRAL MERIDIAN LATITUDE OF ORIGIN N 43°00'00"	W121°17'00" ORIGIN EAST 3,300,000.00	COMBINED FACTOR
15-PSM	224693.2226	3453307.6383	4794.7796	4856.378	+0°23'57.305"	1.0001868426	0.99995800	
16150180	444456.4681	3403261.69	3283.5488	3346.8376	+0°16'28.692"	1.0001721761	1.00001546	
17-TAM	225717.4654	3518483.0946	4998.3084	5059.1076	+0°34'08.473"	1.0002145182	0.99997596	
17-PSM	240850.3841	3451487.6236	4754.0283	4815.5587	+0°23'42.440"	1.0001862087	0.99995932	
18-PSM	251382.0446	3445439.8017	4743.8727	4805.4274	+0°22'47.033"	1.0001841576	0.99995775	
20-DSHD 1927	328944.8824	3377362.5739	4128.7274	4191.4009	+0°12'12.586"	1.0001668347	0.99996979	
20-PSM	266134.1985	3440717.843	4750.3336	4811.8602	+0°22'04.520"	1.0001826142	0.99995590	
23-TAM	256131.5587	3513205.4447	4684.2359	4745.0919	+0°33'24.823"	1.0002119150	0.99998835	
23-PSM	279932.5332	3433545.7362	4715.0634	4776.5912	+0°20'58.676"	1.0001803675	0.99995334	
26-DSHD 1927	313098.7901	3437668.2361	4274.1451	4335.6463	+0°21'41.652"	1.0001816440	0.99997765	
42-WS	288147.6652	3427399.1165	4654.9243	4716.4895	+0°20'01.691"	1.0001785357	0.99995638	
8-TAM	250044.6761	3623321.939	4107.4776	4167.1419	+0°50'38.246"	1.0002793961	1.00008334	
C-112 1934	330873.2063	3442986.4489	4382.5375	4443.8366	+0°22'34.233"	1.0001833483	0.99997419	
C-373	275837.6307	3328081.4281	4372.303	4432.9462	+0°25'48.732"	1.000194118	1.00001073	
CDW PIE	318314.4567	3538455.8282	4590.2543	4649.9218	+0°37'35.599"	1.0002249380	1.00000586	
D-112 1934	320208.7438	3445166.8023	4380.7323	4442.0472	+0°22'53.481"	1.0001840660	0.99997499	
E-112 1934	310161.2761	3445171.4324	4318.6033	4379.9672	+0°22'52.205"	1.0001840677	0.99997796	
F-112	302461.3034	3436172.1873	4330.2669	4391.7848	+0°21'26.199"	1.0001811763	0.99997451	
FOX	223746.6168	3412435.3713	5275.0836	5336.9713	+0°17'34.036"	1.0001744377	0.99992269	
G 112-133	241783.2112	3672661.8192	4430.7581	4489.6838	+0°58'18.951"	1.0003186225	1.00010713	
H 22	266692.186	3545978.3914	4366.1154	4426.6732	+0°38'35.283"	1.0002291023	1.00002071	
K 22	273343.0139	3511644.3931	4468.6276	4529.3537	+0°33'12.426"	1.0002115629	0.99999788	
LIZARD	282310.7991	3569037.0694	5569.6887	5629.5068	+0°42'16.067"	1.0002426652	0.99997684	
MERRILL	318604.2173	3480838.8263	4520.602	4581.1975	+0°28'30.696"	1.0001973471	0.99998159	
MILLICAN	321117.3119	3394811.711	4195.9994	4258.1955	+0°14'57.145"	1.0001702657	0.99997001	
MIDDYMAN	225080.1586	3476561.984	4903.5062	4964.7729	+0°27'35.364"	1.0001956036	0.99996158	
N-22 RESET 1997	284491.49	3480079.6089	4637.7617	4698.6248	+0°28'17.965"	1.0001970350	0.99997569	
N-372 1943	317893.5619	3409950.7746	4265.528	4327.4147	+0°17'16.666"	1.0001737156	0.99997014	
38-DSHD 1927	286906.5028	350726.8903	4636.9283	4697.4672	+0°32'39.073"	1.0002028801	0.99998797	
45-DSHD 1927	214679.3575	3620839.5088	4562.7011	4622.4705	+0°50'05.912"	1.000275722	1.00005979	
P-364 1943	323358.9088	3388852.4988	4169.4403	4231.7913	+0°14'00.938"	1.0001690157	0.99997002	
PERREAULT	387498.7297	3396300.666	3409.403	3472.6327	+0°15'17.037"	1.0001705902	1.00000787	
PETERSEN	394431.5433	3431535.4115	3877.3527	3939.5626	+0°20'53.381"	1.0001797575	0.99999470	
POTTERFIELD	255148.4405	3470610.3209	4765.5321	4826.6674	+0°27'47.640"	1.0001992256	0.99996848	
PRINGLE FLAT	320438.288	3509632.6642	4542.553	4602.6391	+0°33'03.396"	1.0002101875	0.99999338	
R-372 1943	317929.7664	3425408.9086	4248.2436	4309.9114	+0°19'46.294"	1.0001779607	0.99997521	
SWEET	254996.8728	3566421.2362	4357.1064	4417.4738	+0°41'44.860"	1.0002410669	1.00003310	
TAM 30	285239.7563	3541132.0416	4503.627	4563.8891	+0°37'53.705"	1.0002264053	1.00001145	
U-372 1943	306655.3362	3454649.0881	4364.8821	4426.0663	+0°24'21.295"	1.0001813129	0.99997899	
W-372 1943	302546.6733	3465852.7392	4418.4046	4479.3766	+0°26'06.535"	1.0001914139	0.99998054	
X 373	236030.6818	3588893.7407	4370.8948	4431.1483	+0°45'11.170"	1.000253218	1.00004670	
Y-372 1943	298570.0649	3476106.4283	4537.47	4598.2808	+0°27'42.744"	1.0001954184	0.99997886	
Z-111 1934	356934.5011	3448337.3754	3589.3705	3650.5709	+0°23'28.415"	1.0001851281	1.00001381	

SCALE 1" = 7 MILES

- LEGEND
- ▲ CONTROL POINTS HELD FIX (X, Y, & Z)
 - ORTHOMETRIC HEIGHT HELD FIX & NEW (X & Y)
 - NEW CONTROL POINTS (X, Y, & Z)

W.C. Kauffman

REVISION 6-30-99

DESCHUTES COUNTY SURVEYOR
12-30-98 BY: J. O'Leary



DESCHUTES COUNTY SURVEYOR FIELD OFFICE
6150 SE 27TH STREET BEND, OREGON 97702 PHONE 530-4609

DATE: 12/20/1998
DRAWN BY: BILL KAUFFMAN
CHECKED BY: W.C.K.
DWG NAME: NONE

GPS CONTROL SURVEY
FOR
DESCHUTES COUNTY SURVEYOR
LOCATED IN EASTERN DESCHUTES COUNTY

SHEET
1
OF
1